

CCSEW Control Operators

Explosionproof

Push Button Components. Momentary Contact	20
Pilot Light Components.....	21
Lighted Push Button Components. Momentary Contact	22
Mushroom Head Push Button Components.....	23
Miniature	24
Two Position Selector Switch Components Maintained Contact, Spring Return	25
Three Position Selector Switch Components Maintained Contact	26
Spring Return.....	27
Two Position Selector Switch Components Key Operated Maintained Contact, Spring Return to Center	28
Three Position Selector Switch Components Key Operated Maintained Contact.....	29
Spring Return	30
Accessories	31
Options, Accessories and Namplates	32
Dimensions	33

CCSEW Series: Explosionproof Push Button Components. Momentary Contact

Class I, Div. 1 & 2 Groups B, C, D
Class II, Div. 1 & 2 Groups E, F, G
Class III NEMA 4, 7BCD, 9EFG

Sample Catalog Number

CEPDBA-L

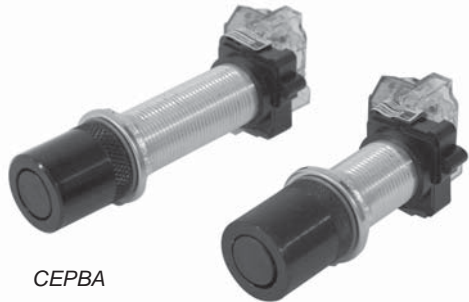
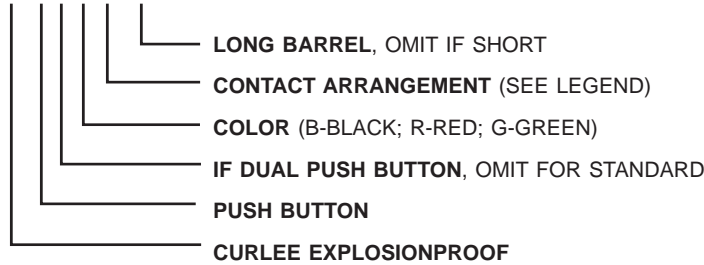

CEPBA



CEPDGRA

Single Push Buttons

Contacts (1)	Button Color	Catalog Number	
		Short Barrel	Long Barrel
1 N.O.	Black	CEPBA	CEPBA-L
1 N.O.	Red	CEPRA	CEPRA-L
1 N.O.	Green	CEPGA	CEPGA-L
2 N.O.	Black	CEPBB	CEPBB-L
2 N.O.	Red	CEPRB	CEPRB-L
2 N.O.	Green	CEPGB	CEPGB-L
1 N.C.	Black	CEPBC	CEPBC-L
1 N.C.	Red	CEPRC	CEPRC-L
1 N.C.	Green	CEPGC	CEPGC-L
2 N.C.	Black	CEPBD	CEPBD-L
2 N.C.	Red	CEPRD	CEPRD-L
2 N.C.	Green	CEPGD	CEPGD-L
1 N.O. & 1 N.C.	Black	CEPBE	CEPBE-L
1 N.O. & 1 N.C.	Red	CEPRE	CEPRE-L
1 N.O. & 1 N.C.	Green	CEPGE	CEPGE-L
2 N.O. & 2 N.C.	Black	CEPBF	CEPBF-L
2 N.O. & 2 N.C.	Red	CEPRF	CEPRF-L
2 N.O. & 2 N.C.	Green	CEPGF	CEPGF-L

(1) N.O. = Normally Open; N.C. = Normally Closed

Dual Push Buttons

Contacts (1)	Button Color	Catalog Number	
		Short Barrel	Long Barrel
1 N.O.	Green/Red	CEPDGRA	CEPDGRA-L
1 N.O.	Black/Black	CEPDDBA	CEPDDBA-L
2 N.O.	Green/Red	CEPDGRB	CEPDGRB-L
2 N.O.	Black/Black	CEPDDBB	CEPDDBB-L
1 N.C.	Green/Red	CEPDGRC	CEPDGRC-L
1 N.C.	Black/Black	CEPDDBC	CEPDDBC-L
2 N.C.	Green/Red	CEPDGRD	CEPDGRD-L
2 N.C.	Black/Black	CEPDDBD	CEPDDBD-L
1 N.O. & 1 N.C.	Green/Red	CEPDGRE	CEPDGRE-L
1 N.O. & 1 N.C.	Black/Black	CEPDDBE	CEPDDBE-L
2 N.O. & 2 N.C.	Green/Red	CEPDGRF	CEPDGRF-L
2 N.O. & 2 N.C.	Black/Black	CEPDDBF	CEPDDBF-L

Note: Use long barrel devices on enclosure applications with cover thickness exceeding 1 inch. See Options page for legend plates. All Operators are 3/4" NPSM.

CCSEW Series: Explosionproof Pilot Light Components

Class I, Div. 1 & 2 Groups B, C, D
Class II, Div. 1 & 2 Groups E, F, G
Class III NEMA 4, 7BCD, 9EFG

Sample Catalog Number

CEPLG1A-L

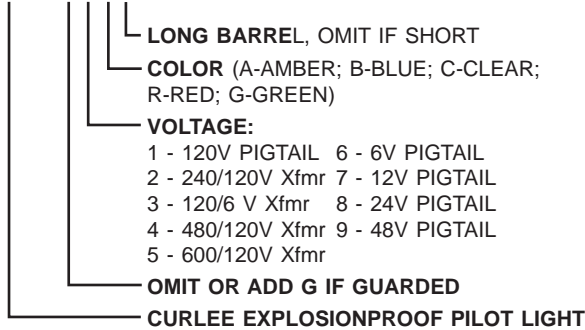

Standard



Guarded

Voltage	Lens Color	Pilot Light		Guarded Pilot Light	
		Short Barrel	Long Barrel	Short Barrel	Long Barrel
120V AC/DC Pigtail	Amber	CEPL1A	CEPL1A-L	CEPLG1A	CEPLG1A-L
	Red	CEPL1R	CEPL1R-L	CEPLG1R	CEPLG1R-L
	Green	CEPL1G	CEPL1G-L	CEPLG1G	CEPLG1G-L
	Clear	CEPL1C	CEPL1C-L	CEPLG1C	CEPLG1C-L
	Blue	CEPL1B	CEPL1B-L	CEPLG1B	CEPLG1B-L
240V AC Transformer w/120V Lamp	Amber	CEPL2A	CEPL2A-L	CEPLG2A	CEPLG2A-L
	Red	CEPL2R	CEPL2R-L	CEPLG2R	CEPLG2R-L
	Green	CEPL2G	CEPL2G-L	CEPLG2G	CEPLG2G-L
	Clear	CEPL2C	CEPL2C-L	CEPLG2C	CEPLG2C-L
	Blue	CEPL2B	CEPL2B-L	CEPLG2B	CEPLG2B-L
120V AC Transformer w/6V Lamp	Amber	CEPL3A	CEPL3A-L	CEPLG3A	CEPLG3A-L
	Red	CEPL3R	CEPL3R-L	CEPLG3R	CEPLG3R-L
	Green	CEPL3G	CEPL3G-L	CEPLG3G	CEPLG3G-L
	Clear	CEPL3C	CEPL3C-L	CEPLG3C	CEPLG3C-L
	Blue	CEPL3B	CEPL3B-L	CEPLG3B	CEPLG3B-L
480V AC Transformer w/120V Lamp	Amber	CEPL4A	CEPL4A-L	CEPLG4A	CEPLG4A-L
	Red	CEPL4R	CEPL4R-L	CEPLG4R	CEPLG4R-L
	Green	CEPL4G	CEPL4G-L	CEPLG4G	CEPLG4G-L
	Clear	CEPL4C	CEPL4C-L	CEPLG4C	CEPLG4C-L
	Blue	CEPL4B	CEPL4B-L	CEPLG4B	CEPLG4B-L
600V AC Transformer w/120V Lamp	Amber	CEPL5A	CEPL5A-L	CEPLG5A	CEPLG5A-L
	Red	CEPL5R	CEPL5R-L	CEPLG5R	CEPLG5R-L
	Green	CEPL5G	CEPL5G-L	CEPLG5G	CEPLG5G-L
	Clear	CEPL5C	CEPL5C-L	CEPLG5C	CEPLG5C-L
	Blue	CEPL5B	CEPL5B-L	CEPLG5B	CEPLG5B-L
6V AC/DC Pigtail	Amber	CEPL6A	CEPL6A-L	CEPLG6A	CEPLG6A-L
	Red	CEPL6R	CEPL6R-L	CEPLG6R	CEPLG6R-L
	Green	CEPL6G	CEPL6G-L	CEPLG6G	CEPLG6G-L
	Clear	CEPL6C	CEPL6C-L	CEPLG6C	CEPLG6C-L
	Blue	CEPL6B	CEPL6B-L	CEPLG6B	CEPLG6B-L
12V AC/DC Pigtail	Amber	CEPL7A	CEPL7A-L	CEPLG7A	CEPLG7A-L
	Red	CEPL7R	CEPL7R-L	CEPLG7R	CEPLG7R-L
	Green	CEPL7G	CEPL7G-L	CEPLG7G	CEPLG7G-L
	Clear	CEPL7C	CEPL7C-L	CEPLG7C	CEPLG7C-L
	Blue	CEPL7B	CEPL7B-L	CEPLG7B	CEPLG7B-L
24V AC/DC Pigtail	Amber	CEPL8A	CEPL8A-L	CEPLG8A	CEPLG8A-L
	Red	CEPL8R	CEPL8R-L	CEPLG8R	CEPLG8R-L
	Green	CEPL8G	CEPL8G-L	CEPLG8G	CEPLG8G-L
	Clear	CEPL8C	CEPL8C-L	CEPLG8C	CEPLG8C-L
	Blue	CEPL8B	CEPL8B-L	CEPLG8B	CEPLG8B-L
48V AC/DC Pigtail	Amber	CEPL9A	CEPL9A-L	CEPLG9A	CEPLG9A-L
	Red	CEPL9R	CEPL9R-L	CEPLG9R	CEPLG9R-L
	Green	CEPL9G	CEPL9G-L	CEPLG9G	CEPLG9G-L
	Clear	CEPL9C	CEPL9C-L	CEPLG9C	CEPLG9C-L
	Blue	CEPL9B	CEPL9B-L	CEPLG9B	CEPLG9B-L

CCSEW Control Operators: Explosionproof Lighted Push Button Components. Momentary Contact

Class I, Div. 1 & 2 Groups B, C, D
Class II, Div. 1 & 2 Groups E, F, G
Class III NEMA 4, 7BCD, 9EFG

Sample Catalog Number

CEPTAA-L

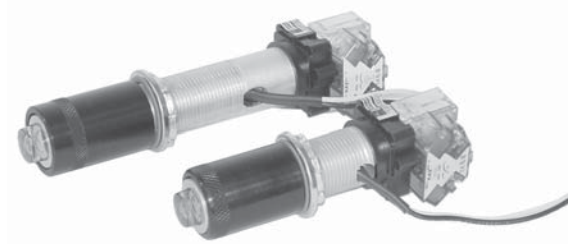
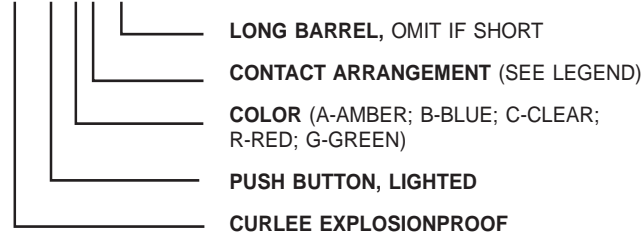

Contacts (1)	Lens Color	Catalog Number	
		Short Barrel	Long Barrel
1 N.O.	Amber	CEPTAA	CEPTAA-L
1 N.O.	Red	CEPTRA	CEPTRA-L
1 N.O.	Green	CEPTGA	CEPTGA-L
1 N.O.	Clear	CEPTCA	CEPTCA-L
1 N.O.	Blue	CEPTBA	CEPTBA-L
2 N.O.	Amber	CEPTAB	CEPTAB-L
2 N.O.	Red	CEPTRB	CEPTRB-L
2 N.O.	Green	CEPTGB	CEPTGB-L
2 N.O.	Clear	CEPTCB	CEPTCB-L
2 N.O.	Blue	CEPTBB	CEPTBB-L
1 N.C.	Amber	CEPTAC	CEPTAC-L
1 N.C.	Red	CEPTRC	CEPTRC-L
1 N.C.	Green	CEPTGC	CEPTGC-L
1 N.C.	Clear	CEPTCC	CEPTCC-L
1 N.C.	Blue	CEPTBC	CEPTBC-L

Contacts (1)	Lens Color	Catalog Number	
		Short Barrel	Long Barrel
2 N.C.	Amber	CEPTAD	CEPTAD-L
2 N.C.	Red	CEPTRD	CEPTRD-L
2 N.C.	Green	CEPTGD	CEPTGD-L
2 N.C.	Clear	CEPTCD	CEPTCD-L
2 N.C.	Blue	CEPTBD	CEPTBD-L
1 N.O. & 1 N.C.	Amber	CEPTAE	CEPTAE-L
1 N.O. & 1 N.C.	Red	CEPTRE	CEPTRE-L
1 N.O. & 1 N.C.	Green	CEPTGE	CEPTGE-L
1 N.O. & 1 N.C.	Clear	CEPTCE	CEPTCE-L
1 N.O. & 1 N.C.	Blue	CEPTBE	CEPTBE-L
2 N.O. & 2 N.C.	Amber	CEPTAF	CEPTAF-L
2 N.O. & 2 N.C.	Red	CEPTRF	CEPTRF-L
2 N.O. & 2 N.C.	Green	CEPTGF	CEPTGF-L
2 N.O. & 2 N.C.	Clear	CEPTCF	CEPTCF-L
2 N.O. & 2 N.C.	Blue	CEPTBF	CEPTBF-L

(1) N.O. = Normally Open; N.C. = Normally Closed

* 120V Standard

Note: Use long barrel devices on enclosure applications with cover thickness exceeding 1 inch. See Options page for legend plates.
All operators are 3/4" NPSM.

Contact Legend

A 1 N.O.	D 2 N.C.
B 2 N.O.	E 1 N.O. & 1 N.C.
C 1 N.C.	F 2 N.O. & 2 N.C.

CCSEW Control Operators: Explosionproof Mushroom Head Push Button Components

Class I, Div. 1 & 2 Groups B, C, D
Class II, Div. 1 & 2 Groups E, F, G
Class III NEMA 4, 7BCD, 9EFG

Sample Catalog Number

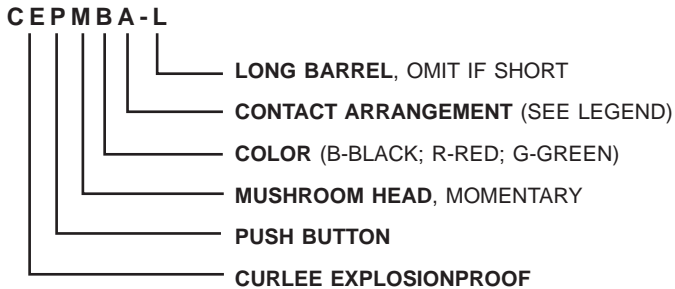

Momentary Contact

Contacts (1)	Lens Color	Catalog Number	
		Short Barrel	Long Barrel
1 N.O.	Black	CEPMBA	CEPMBA-L
1 N.O.	Red	CEPMRA	CEPMRA-L
1 N.O.	Green	CEPMGA	CEPMGA-L
2 N.O.	Black	CEPMBB	CEPMBB-L
2 N.O.	Red	CEPMRB	CEPMRB-L
2 N.O.	Green	CEPMGB	CEPMGB-L
1 N.C.	Black	CEPMBC	CEPMBC-L
1 N.C.	Red	CEPMRC	CEPMRC-L
1 N.C.	Green	CEPMGC	CEPMGC-L

Contacts (1)	Lens Color	Catalog Number	
		Short Barrel	Long Barrel
2 N.C.	Black	CEPMBD	CEPMBD-L
2 N.C.	Red	CEPMRD	CEPMRD-L
2 N.C.	Green	CEPMGD	CEPMGD-L
1 N.O. & 1 N.C.	Black	CEPMBE	CEPMBE-L
1 N.O. & 1 N.C.	Red	CEPMRE	CEPMRE-L
1 N.O. & 1 N.C.	Green	CEPMGE	CEPMGE-L
2 N.O. & 2 N.C.	Black	CEPMBF	CEPMBF-L
2 N.O. & 2 N.C.	Red	CEPMRF	CEPMRF-L
2 N.O. & 2 N.C.	Green	CEPMGF	CEPMGF-L

(1) N.O. = Normally Open; N.C. = Normally Closed

Note: Use long barrel devices on enclosure applications with cover thickness exceeding 1 inch. See options page for legend plates. All Operators are 3/4" NPSM.

Maintained Contact

Contacts (1)	Lens Color	Catalog Number	
		Short Barrel	Long Barrel
1 N.O.	Black	CEPMCBA	CEPMCBA-L
1 N.O.	Red	CEPMCRA	CEPMCRA-L
1 N.O.	Green	CEPMCGA	CEPMCGA-L
2 N.O.	Black	CEPMCBB	CEPMCBB-L
2 N.O.	Red	CEPMCRB	CEPMCRB-L
2 N.O.	Green	CEPMCGB	CEPMCGB-L
1 N.C.	Black	CEPMCBC	CEPMCBC-L
1 N.C.	Red	CEPMCRC	CEPMCRC-L
1 N.C.	Green	CEPMCGC	CEPMCGC-L

Contacts (1)	Lens Color	Catalog Number	
		Short Barrel	Long Barrel
2 N.C.	Black	CEPMCBD	CEPMCBD-L
2 N.C.	Red	CEPMCRD	CEPMCRD-L
2 N.C.	Green	CEPMCGD	CEPMCGD-L
1 N.O. & 1 N.C.	Black	CEPMCBE	CEPMCBE-L
1 N.O. & 1 N.C.	Red	CEPMCRE	CEPMCRE-L
1 N.O. & 1 N.C.	Green	CEPMCGE	CEPMCGE-L
2 N.O. & 2 N.C.	Black	CEPMCBF	CEPMCBF-L
2 N.O. & 2 N.C.	Red	CEPMCRF	CEPMCRF-L
2 N.O. & 2 N.C.	Green	CEPMCGF	CEPMCGF-L

(1) N.O. = Normally Open; N.C. = Normally Closed

CCSEW Miniature Control Operators

Explosionproof

Features

- Installation centers reduced to 1" centers.
- Allows selection of smaller enclosures.
- 3/8 - 16 thread.
- Stainless steel actuator shaft.
- Solid silver contacts rated 6A @ 125VAC, A @ 250VAC.



Selection Table

Catalog Number	Contact Configuration
CEPMOB-3	DPDT Maintained
CEPMOB-4	DPDT Momentary

CCSEW Control Operators Explosionproof

Class I, Div. 1 & 2 Groups B, C, D
Class II, Div. 1 & 2 Groups E, F, G
Class III NEMA 4, 7BCD, 9EFG

Two Position Selector Switch Components. 10 Amp 600 VAC

Sample Catalog Number

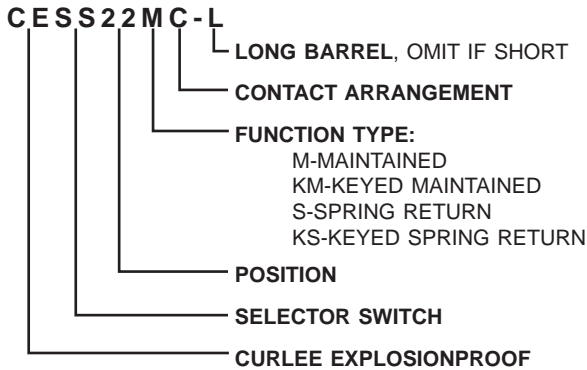

Maintained Contact

Contact	Lever Position		Catalog Number		Contact Block L	Position R	Cam Location
	X=Closed Left	O=Open Right	Standard Bushing	Long Bushing			
1	O	X	CESS22MG	CESS22MG-L	NO	-	2
1	X	O	CESS22MH	CESS22MH-L	-	NO	2
1	O	X	CESS22ML	CESS22ML-L	NO	NO	2
2	X	O					
1	O	X	CESS22MM	CESS22MM-L	NO	NC	2
2	O	X					
1	X	O	CESS22MR	CESS22MR-L	2NC	2NC	2
2	O	X					
3	X	O					
4	O	X					

Spring Return Left to Right

Contact	Lever Position		Catalog Number		Contact Block L	Position R	Cam Location
	X=Closed Left	O=Open Right	Standard Bushing	Long Bushing			
1	O	X	CESS22SG	CESS22SG-L	NO	-	2
1	X	O	CESS22SH	CESS22SH-L	-	NO	2
1	O	X	CESS22SL	CESS22SL-L	NO	NO	2
2	X	O					
1	O	X	CESS22SM	CESS22SM-L	NO	NC	2
2	O	X					
1	X	O	CESS22SR	CESS22SR-L	2NC	2NC	2
2	O	X					
3	X	O					
4	O	X					

Note: Use long barrel devices on enclosure applications with cover thickness exceeding 1 inch. See Options page for legend plates.
All Operators are 3/4" NPSM.

Visit our website at www.egs-curlee.com or
contact **Technical Services** at (800) 631-6815 with any questions.

CCSEW Control Operators

Explosionproof

Three Position Selector Switch Components.
Maintained Contact. 10 Amp 600 VAC

Class I, Div. 1 & 2 Groups B, C, D
Class II, Div. 1 & 2 Groups E, F, G
Class III NEMA 4, 7BCD, 9EFG

Selection Table

Contact	Lever Position			Catalog Number		Contact Block Position		Cam Location
	X=Closed Left	Center	O=Open Right	Standard Bushing	Long Bushing	L	R	
1	O	O	X	CESS31MN	CESS31MN-L	NC	NC	1
2	X	O	O					
2	X	O	O	CESS31MQ	CESS31MQ-L	-	NOC	1
4	O	X	X					
1	O	O	X	CESS34MN	CESS34MN-L	NC	NC	4
2	O	X	O					
1	X	O	O	CESS32MN	CESS32MN-L	NC	NC	2
2	O	X	O					
1	O	O	X	CESS31MS	CESS31MS-L	2NC	2NC	1
2	X	O	O					
3	O	O	X					
4	X	O	O					
1	O	O	X	CESS34MS	CESS34MS-L	2NC	2NC	4
2	O	X	O					
3	O	O	X					
4	O	X	O					
1	X	O	O	CESS32MS	CESS32MS-L	2NC	2NC	2
2	O	X	O					
3	X	O	O					
4	O	X	O					

Note: Use long barrel devices on enclosure applications with cover thickness exceeding 1 inch. See Options page for legend plates.
All Operators are 3/4" NPSM.

CCSEW Control Operators

Explosionproof

Three Position Selector Switch Components.
Spring Return. 10 Amp 600 VAC

Class I, Div. 1 & 2 Groups B, C, D
Class II, Div. 1 & 2 Groups E, F, G
Class III NEMA 4, 7BCD, 9EFG

Selection Table

Contact	Lever Position			Catalog Number		Contact Block Position		Cam Location																																																																																																			
	X=Closed Left	Center	O=Open Right	Standard Bushing	Long Bushing	L	R																																																																																																				
1	O	O	X	CESS31SN	CESS31SN-L	NC	NC	1																																																																																																			
2	X	O	O						2	X	O	O	CESS31SQ	CESS31SQ-L	-	NOC	1	4	O	X	X	1	O	O	X	CESS34SN	CESS34SN-L	NC	NC	4	2	O	X	O	1	X	O	O	CESS32SN	CESS32SN-L	NC	NC	2	2	O	X	O	1	X	O	O	CESS31SS	CESS31SS-L	2NC	2NC	1	2	O	O	X	3	X	O	O	4	O	O	X	1	O	O	X	CESS34SS	CESS34SS-L	2NC	2NC	4	2	O	X	O	3	O	O	X	4	O	X	O	1	X	O	O	CESS32SS	CESS32SS-L	2NC	2NC	2	2	O	X	O	3	X	O	O	4
2	X	O	O	CESS31SQ	CESS31SQ-L	-	NOC	1																																																																																																			
4	O	X	X						1	O	O	X	CESS34SN	CESS34SN-L	NC	NC	4	2	O	X	O	1	X	O	O	CESS32SN	CESS32SN-L	NC	NC	2	2	O	X	O	1	X	O	O	CESS31SS	CESS31SS-L	2NC	2NC	1	2	O	O	X	3	X	O	O						4	O	O	X	1	O	O	X	CESS34SS	CESS34SS-L	2NC	2NC	4	2	O	X						O	3	O	O	X	4	O	X	O	1	X	O	O	CESS32SS	CESS32SS-L	2NC						2NC	2	2	O	X	O	3	X	O
1	O	O	X	CESS34SN	CESS34SN-L	NC	NC	4																																																																																																			
2	O	X	O						1	X	O	O	CESS32SN	CESS32SN-L	NC	NC	2	2	O	X	O	1	X	O	O	CESS31SS	CESS31SS-L	2NC	2NC	1	2	O	O	X	3	X	O	O						4	O	O	X	1	O	O	X	CESS34SS	CESS34SS-L	2NC	2NC	4	2	O	X	O	3	O	O	X						4	O	X	O	1	X	O	O	CESS32SS	CESS32SS-L	2NC	2NC	2	2	O	X	O	3	X	O	O				4	O	X	O										
1	X	O	O	CESS32SN	CESS32SN-L	NC	NC	2																																																																																																			
2	O	X	O						1	X	O	O	CESS31SS	CESS31SS-L	2NC	2NC	1	2	O	O	X	3	X	O	O						4	O	O	X	1	O	O	X	CESS34SS	CESS34SS-L	2NC	2NC	4	2	O	X	O	3	O	O	X						4	O	X	O	1	X	O	O	CESS32SS	CESS32SS-L	2NC	2NC	2	2	O	X	O	3	X	O	O						4	O	X	O																					
1	X	O	O	CESS31SS	CESS31SS-L	2NC	2NC	1																																																																																																			
2	O	O	X																																																																																																								
3	X	O	O																																																																																																								
4	O	O	X						1	O	O	X	CESS34SS	CESS34SS-L	2NC	2NC	4	2	O	X	O	3	O	O	X	4	O	X	O	1	X	O	O	CESS32SS	CESS32SS-L	2NC	2NC	2	2	O	X	O	3	X	O	O	4	O	X	O																																																									
1	O	O	X	CESS34SS	CESS34SS-L	2NC	2NC	4																																																																																																			
2	O	X	O																																																																																																								
3	O	O	X																																																																																																								
4	O	X	O						1	X	O	O	CESS32SS	CESS32SS-L	2NC	2NC	2	2	O	X	O	3	X	O	O	4	O	X	O																																																																														
1	X	O	O	CESS32SS	CESS32SS-L	2NC	2NC	2																																																																																																			
2	O	X	O																																																																																																								
3	X	O	O																																																																																																								
4	O	X	O																																																																																																								

CCSEW Control Operators

Explosionproof

Two Position Selector Switch Components -
Key Operated^{1,2} 10 Amp 600 VAC

Class I, Div. 1 & 2 Groups B, C, D
 Class II, Div. 1 & 2 Groups E, F, G
 Class III NEMA 4, 7BCD, 9EFG

Maintained Contact

Contact	Lever Position		Catalog Number		Contact Block Position		Cam Location
	X=Closed Left	O=Open Right	Standard Bushing	Long Bushing	L	R	
1	O	X	CESS22KMG	CESS22KMG-L	NO	-	2
1	X	O	CESS22KMH	CESS22KMH-L	-	NO	2
1	O	X	CESS22KML	CESS22KML-L	NO	NO	2
2	X	O					
1	O	X	CESS22KMM	CESS22KMM-L	NO	NC	2
2	O	X					
1	X	O	CESS22KMR	CESS22KMR-L	2NC	2NC	2
2	O	X					
3	X	O					
4	O	X					

Spring Return Right to Center

Contact	Lever Position		Catalog Number		Contact Block Position		Cam Location
	X=Closed Left	O=Open Right	Standard Bushing	Long Bushing	L	R	
1	O	X	CESS22KSG	CESS22KSG-L	NO	-	2
1	X	O	CESS22KSH	CESS22KSH-L	-	NO	2
1	O	X	CESS22KSL	CESS22KSL-L	NO	NO	2
2	X	O					
1	O	X	CESS22KSM	CESS22KSM-L	NO	NC	2
2	O	X					
1	X	O	CESS22KSR	CESS22KSR-L	2NC	2NC	2
2	O	X					
3	X	O					
4	O	X					

- (1) Locks are normally provided keyed differently. If keyed-alike locks are required, specify suffix KA1 and a standard type of identical locks will be provided. If a unique set of keyed-alike locks are required, specify and consult factory for delivery.
- (2) Key removable from one field selectable position only. Consult factory for key removable in two positions.

Note: Use long barrel devices on enclosure applications with cover thickness exceeding 1 inch. See Options page for legend plates.
 All Operators are 3/4" NPSM.

CCSEW Control Operators Explosionproof

Class I, Div. 1 & 2 Groups B, C, D
Class II, Div. 1 & 2 Groups E, F, G
Class III NEMA 4, 7BCD, 9EFG

Three Position Selector Switch Components -
Key Operated^{1,2} 10 Amp 600 VAC

Maintained Contact

Contact	Lever Position			Catalog Number		Contact Block Position		Cam Location
	X=Closed Left	Center	O=Open Right	Standard Bushing	Long Bushing	L	R	
1 2	O X	O O	X O	CESS31KMN	CESS31KMN-L	NC	NC	1
2 4	X O	O X	O X	CESS31KMQ	CESS31KMQ-L	-	NOC	1
1 2	O O	O X	X O	CESS34KMN	CESS34KMN-L	NC	NC	4
1 2	X O	O X	O O	CESS32KMN	CESS32KMN-L	NC	NC	2
1 2 3 4	X O X O	O O O O	O X O X	CESS31KMS	CESS31KMS-L	2NC	2NC	1
1 2 3 4	O O O O	O X O X	X O X O	CESS34KMS	CESS34KMS-L	2NC	2NC	4
1 2 3 4	X O X O	O X O X	O O O O	CESS32KMS	CESS32KMS-L	2NC	2NC	2

(1) Locks are normally provided keyed differently. If keyed-alike locks are required, specify suffix KA1 and a standard type of identical locks will be provided. If a unique set of keyed-alike locks are required, specify and consult factory for delivery.

(2) Key removable from one field selectable position only. Consult factory for key removable in two positions.

Note: Use long barrel devices on enclosure applications with cover thickness exceeding 1 inch. See Options page for legend plates.
All Operators are 3/4" NPSM.

CCSEW Control Operators Explosionproof

Three Position Selector Switch Components -
Key Operated^{1,2}. 10 Amp 600 VAC

Class I, Div. 1 & 2 Groups B, C, D
Class II, Div. 1 & 2 Groups E, F, G
Class III NEMA 4, 7BCD, 9EFG

Spring Return

Contact	Lever Position			Catalog Number*		Contact Block L	Position R	Cam Location
	X=Closed Left	Center	O=Open Right	Standard Bushing	Long Bushing			
1	X	O	O	CESS31KSN	CESS31KSN-L	NC	NC	1
2	O	O	X					
2	X	O	O	CESS31KSQ	CESS31KSQ-L	-	NOC	1
4	O	X	X					
1	O	O	X	CESS34KSN	CESS34KSN-L	NC	NC	4
2	O	X	O					
1	X	O	O	CESS32KSN	CESS32KSN-L	NC	NC	2
2	O	X	O					
1	X	O	O	CESS31KSS	CESS31KSS-L	2NC	2NC	1
2	O	O	X					
3	X	O	O					
4	O	O	X					
1	O	O	X	CESS34KSS	CESS34KSS-L	2NC	2NC	4
2	O	X	O					
3	O	O	X					
4	O	X	O					
1	X	O	O	CESS32KSS	CESS32KSS-L	2NC	2NC	2
2	O	X	O					
3	X	O	O					
4	O	X	O					

* Use suffix -SL for spring return left to center, use suffix -SR for spring return right to center.

(1) Locks are normally provided keyed differently. If keyed-alike locks are required, specify suffix KA1 and a standard type of identical locks will be provided. If a unique set of keyed-alike locks are required, specify and consult factory for delivery.





(2) Key removable from one field selectable position only. Consult factory for key removable in two positions.

Note: Use long barrel devices on enclosure applications with cover thickness exceeding 1 inch. See Options page for legend plates.
All Operators are 3/4" NPSM.

CCSEW Control Operators Accessories

Class I, Div. 1 & 2 Groups B, C, D
Class II, Div. 1 & 2 Groups E, F, G
Class III NEMA 4, 7BCD, 9EFG

Selection Table

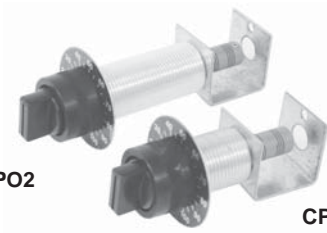
Item	Description	Catalog Number
Rotating Shaft 	Manual operated shaft used for devices requiring external adjustment. The shaft is 1/4" diameter and is provided with a coupling to compensate for misalignment.	CRO250C
Standard Reset Button 	Six inch length can be field modified for specific length. Suitable for use in Class I, Groups B, C & D applications. Add -L for long barrel.	CEPRS
Miniature Reset Button 	Six inch length can be field modified for specific length. Suitable for use in Class I, Groups B, C & D applications. 3/8 - 16 Threads.	CEPRM
Weather Cap 	Field attachable weather cap snaps on easily without the use of adhesives. -Black -Red -Green	CWL CWP-B CWP-R CWP-G
Plug 	3/4" NPSM to plug unused openings.	CPU
Potentiometer Operator 	Operator for use with potentiometers having a 1/4" diameter by 7/8" long shaft. The operator is furnished with a control knob and dial plate marked 0 to 100. Use Long bushing (APO2) for applications where enclosure cover thickness is greater than 7/8".	CPO1 CPO2

Note: Use long barrel devices on enclosure applications with cover thickness exceeding 1 inch. See Options page for legend plates. All Operators are 3/4" NPSM, except when specified otherwise.

CCSEW Control Operators

Options, Accessories, and Nameplates

Optional Features

Item Description	Suffix
Keyed Alike (Selector Switches)	KA1
Additional Keys (Keyed Selector Switches)	441-KEYS

Note: Additional keys may only be purchased when ordering devices.
Keys may not be purchased for devices installed in the field.

Nameplates

Legend Plate	Catalog Number
Start	C441-01
Stop	C441-02
High	C441-03
Low	C441-04
On	C441-05
Off	C441-06
Forward	C441-07
Reverse	C441-08
Open	C441-09
Close	C441-10
Up	C441-11
Down	C441-12
Reset	C441-13
Run	C441-14
Trip	C441-15
Blank	C441-16
Emergency Stop (Red)	C441-17
Special Engraved Legend Plates (Specify Lettering)	C441-16SP
Off On	C441-20
Open Close	C441-21
For - Rev	C441-22
High Low	C441-23
Start Stop	C441-24
Up Down	C441-25
Local Remote	C441-26
Hand Off Auto	C441-30
For Off Rev	C441-31
Open Off Close	C441-32
Off Low High	C441-33
Push to Start/Push to Stop	C441-40

Accessories

Catalog Number	Lamp Description
C6S6-6V	6V
C6S6-12V	12V
C6S6-24V	24V
C6S6-48V	48V
C6S6-120V	120V
C6S6-135V	135V
C6S6-240V	240V

Pilot Light Replacement Kit - Pilot Lights (120V)

Catalog Number	Lens Color
CEPRLAA	Amber
CEPRLAB	Blue
CEPRLAC	Clear
CEPRLAG	Green
CEPRLAR	Red

Guarded Pilot Lights (120V)

Catalog Number	Lens Color
CEPRLAA-G	Amber
CEPRLAB-G	Blue
CEPRLAC-G	Clear
CEPRLAG-G	Green
CEPRLAR-G	Red

Push-to-Test Pilot Lights (120V)

Catalog Number	Lens Color
CEPTRLA-A	Amber
CEPTRLA-B	Blue
CEPTRLA-C	Clear
CEPTRLA-G	Green
CEPTRLA-R	Red

CCSEW Control Operators

Dimensions (Add 1" to length for Contact Block)

Short Barrel (All dimensions are in inches.)

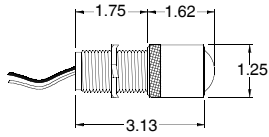

Pilot Light

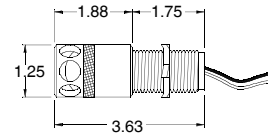

Guarded Pilot Light

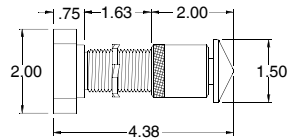

Mushroom Push Button

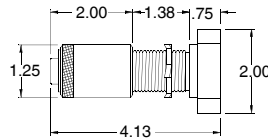

Push-To-Test

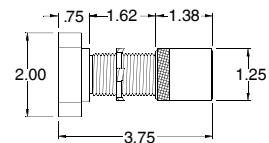

Push Button

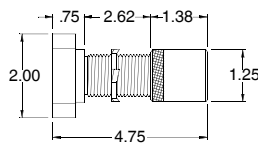

Push Button

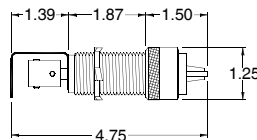

Potentiometer Operator

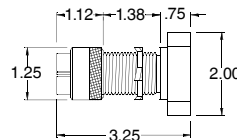

Dual Push Button

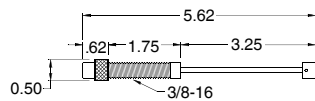

Miniature Reset

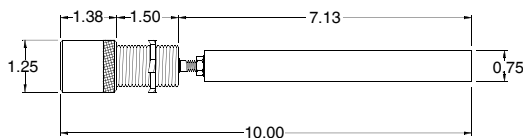

Standard Reset

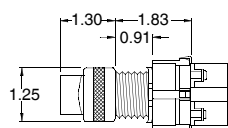

Selector Switch

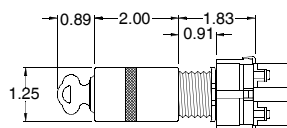

Keyed Selector Switch

Long Barrel (All dimensions are in inches.)

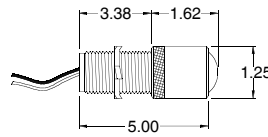

Pilot Light

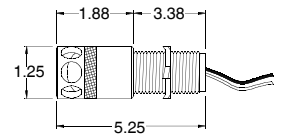

Guarded Pilot Light

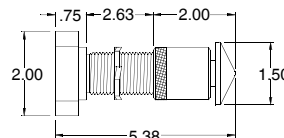

Mushroom Push Button

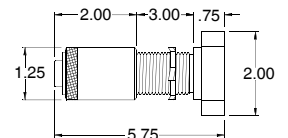

Push-To-Test

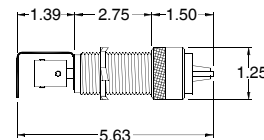

Potentiometer Operator

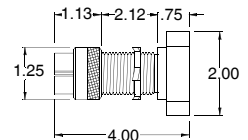

Dual Push Button

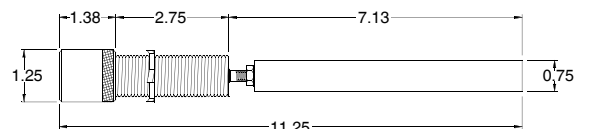

Standard Reset

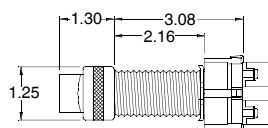

Selector Switch

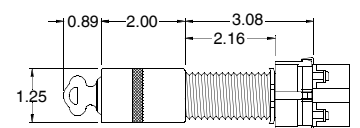

Keyed Selector Switch